

313

Serratura universale intaglio per moneta - Rot. 90° Universal coin lock for wooden and metal furniture - 90° rotation

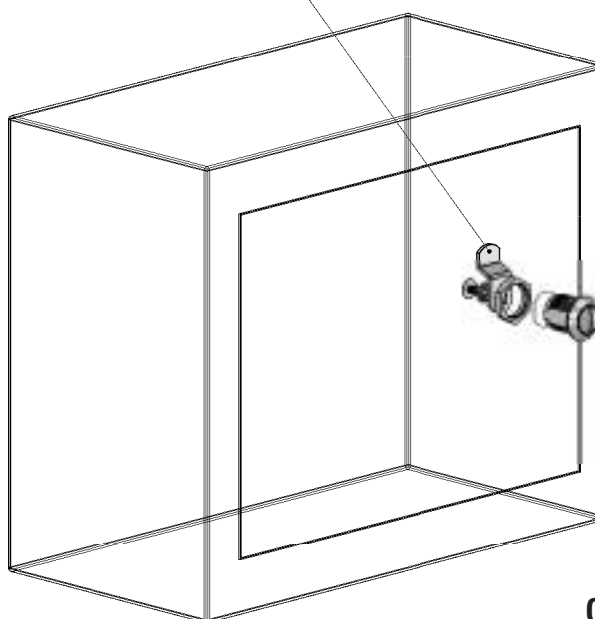
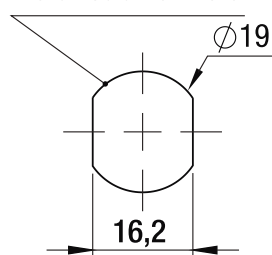
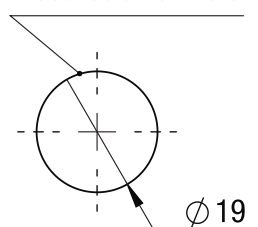
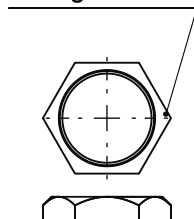
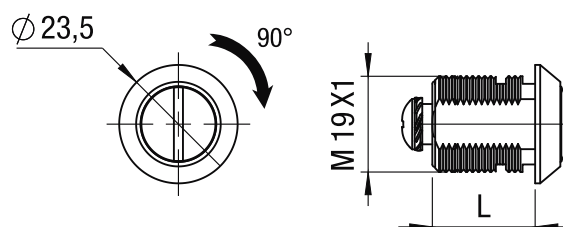

A-B-C-D

Foro Mobile Metallo
Metal Cabinet Hole

Foro Mobile Legno
Wood Cabinet Hole

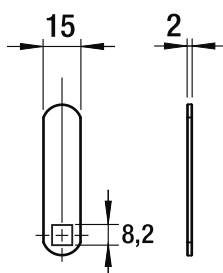
A1013
Dado di fissaggio
Hexagon nut

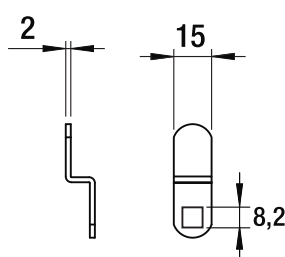
A1015
Clip

A1012
Rondella di fissaggio
Locking Washer

Cilindro
Cylinder

| | |
|----------|-----------|
| L | 16 |
| L | 20 |
| L | 25 |
| L | 30 |

Leva diritta
Straight
Cam Plate

A

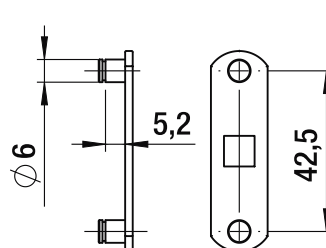
Leva piegata
Bent
Cam Plate

B

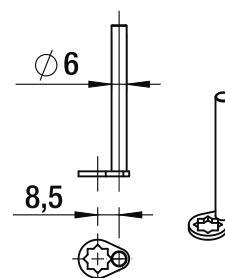
Leva con perni ad asta
Cam Plate with
Lock Bar Pins

C

Perno
Tail

D

Descrizione/Description
Cifratura
Key code

Standard
Optional
Finitura
Finishing

Cromatura
Nickel plating

Brunitura
Black N.P.

Tipo chiave
Key type

Colore impugnatura
Key cap color

Chiave maestra
Master key system

NO
NO

Cilindro estraibile
Interchangeable cylinder

NO
NO