

Guida a Sfere Accoppiata Estrazione Totale con Fori (30 kg)
Full-Extension "coupled" Ball-Bearing Slide with Standard Hole Pattern (30kg)

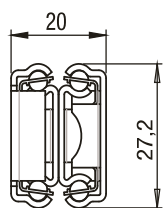

Specifiche
Portata: 30 Kg (450 mm)
Materiale: ferro zincato
Montaggio: laterale

Specifications
Load Capacity: 30 Kg (450 mm)
Material: Galvanized steel
Mounting: Side

Versioni speciali su richiesta
Special versions upon request

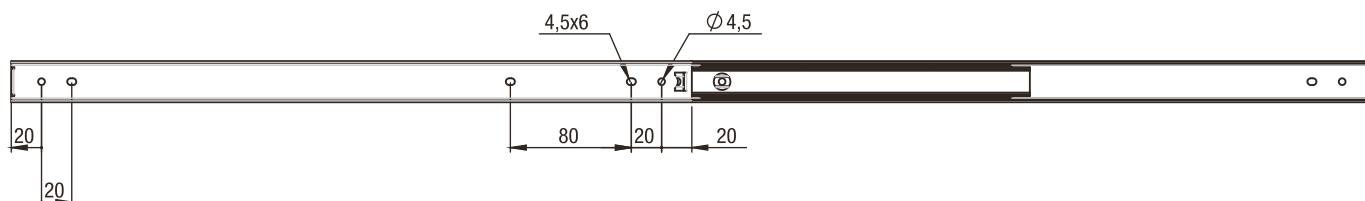
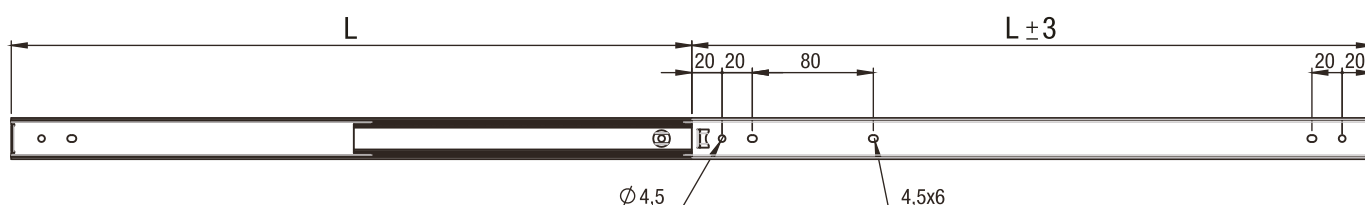

L
200
250
300
350
400
450
500