

Hinges

Cerniere

Serie Euro

4

Cerniere - \varnothing 35
Assemblaggio key hole

Hinges - \varnothing 35
Key hole assembly



Cerniera key hole - acciaio nichelato - Key hole hinge - Nickel plated steel

EURO 4 KEY HOLE 110°

Collo "0"
Sormonto fino 18 mm.

Crank "0"
Full overlay application (up to 18 mm)



250

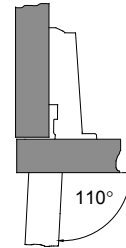

$$H = 18 + K - C$$

$$K = 2,5 \div 3,5$$

H = Base
Mounting plate

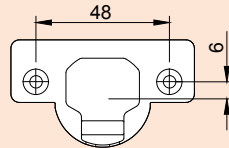
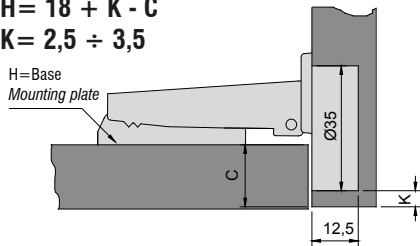

Lavorazione montaggio
Assembly process

Fissaggio a vite
Screw-on



3,5x16
non inclusa

4832

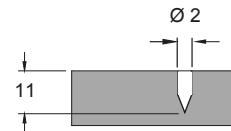

Fissaggio a pressione
Knock-in



Ø 10
premontato

4833

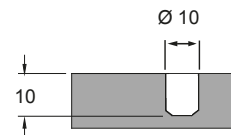

EURO 4 KEY HOLE 110°

Collo "9"
Sormonto fino 10 mm.

Crank "9"
Half overlay application (up to 10 mm)



250

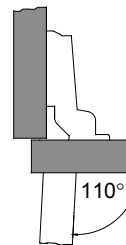

$$H = 9 + K - C$$

$$K = 2,5 \div 3,5$$

H = Base
Mounting plate

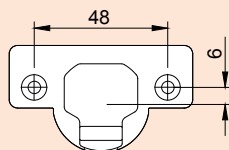
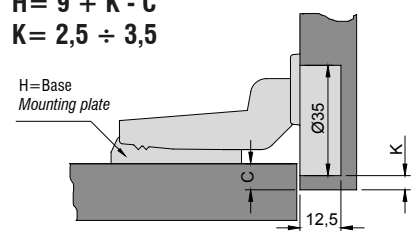

Lavorazione montaggio
Assembly process

Fissaggio a vite
Screw-on



3,5x16
non inclusa

4822

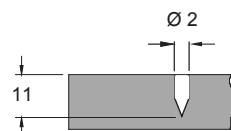

Fissaggio a pressione
Knock-in



Ø 10
premontato

4823

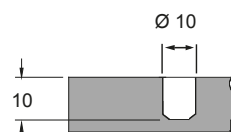

Cerniera key hole - acciaio nichelato - Key hole hinge - Nickel plated steel

EURO 4 KEY HOLE 110°

Collo "18"
Per ante interne

Crank "18"
Inset application

← 250

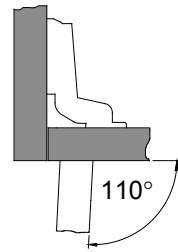

H = 4; A = -1; K = 3
H = 6; A = -1; K = 5

H = Base
Mounting plate

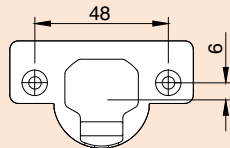
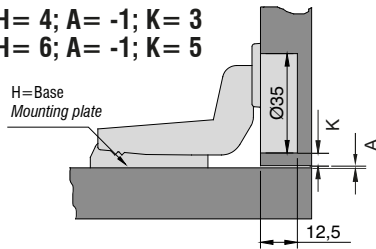

Lavorazione montaggio
Assembly process

Fissaggio a vite
Screw-on



3,5x16
non inclusa

4812

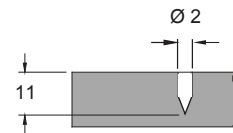

Fissaggio a pressione
Knock-in



Ø 10
premontato

4813

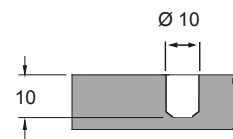

Assemblaggio della cerniera all'anta - Assembling the hinge to the door

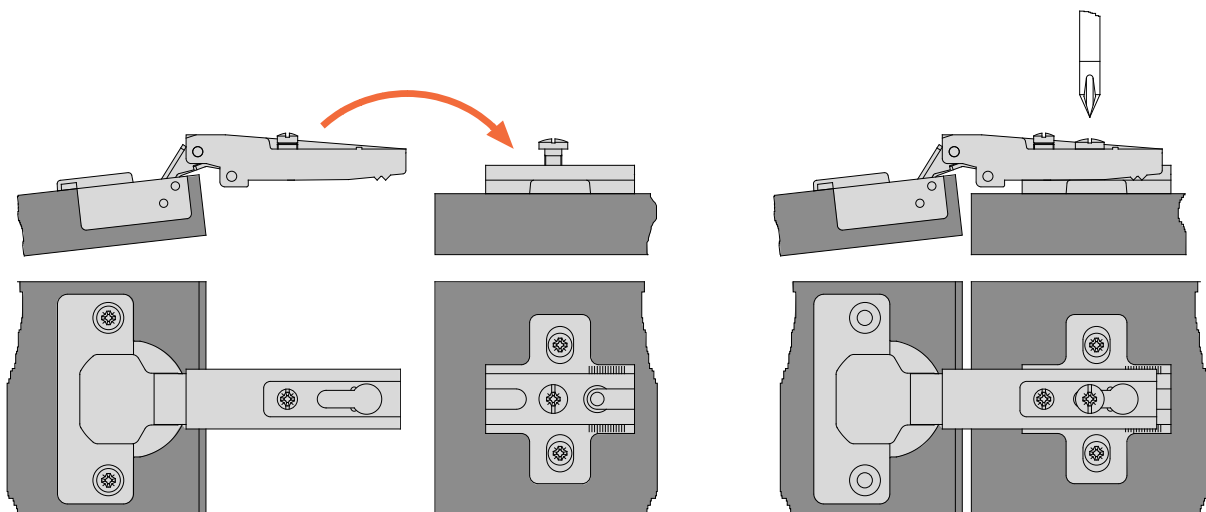

Basette di montaggio per cerniere serie EURO 4

Mounting plates for EURO 4 hinges

Base in acciaio nickelato con fissaggio a vite - Steel nickel plated mounting plate, wood screw fixing

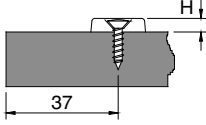
		H	Codice Code
		4 mm	E984BN
		6 mm	E986BN

Base in acciaio nickelato con fissaggio a vite EURO 12 mm - Steel nickel plated mounting plate 12 mm euro screw fixing

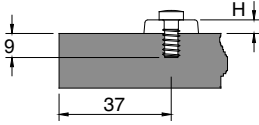
		H	Codice Code
		4 mm	E984DN/12
		6 mm	E986DN/12

Base in acciaio nickelato con fissaggio a vite EURO 14 mm - Steel nickel plated mounting plate 14 euro screw fixing

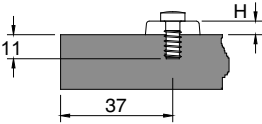
		H	Codice Code
		4 mm	E984DN
		6 mm	E986DN

Base in acciaio nickelato con fissaggio con tassello 5 mm - Steel nickel plated mounting plate 5 mm dowel fixing

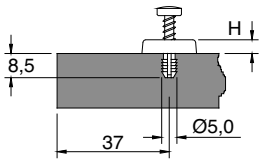
		H	Codice Code
		4 mm	E984E5
		6 mm	E986E5

Base in acciaio nickelato con fissaggio con tassello 10 mm - Steel nickel plated mounting plate 10 mm dowel fixing

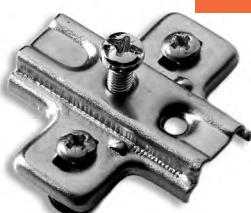
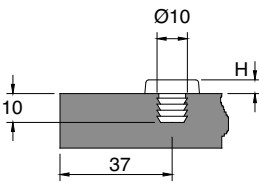
		H	Codice Code
		4 mm	E984F10
		6 mm	E986F10

Informazioni tecniche slide-on - Slide-on technical information

Collo - Crank

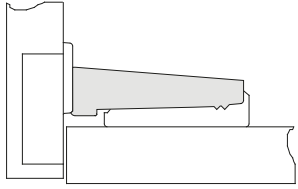
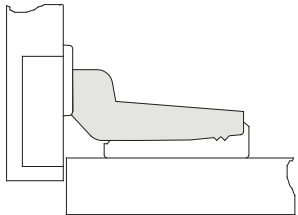
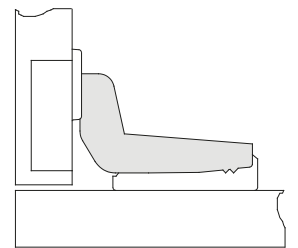
0

9

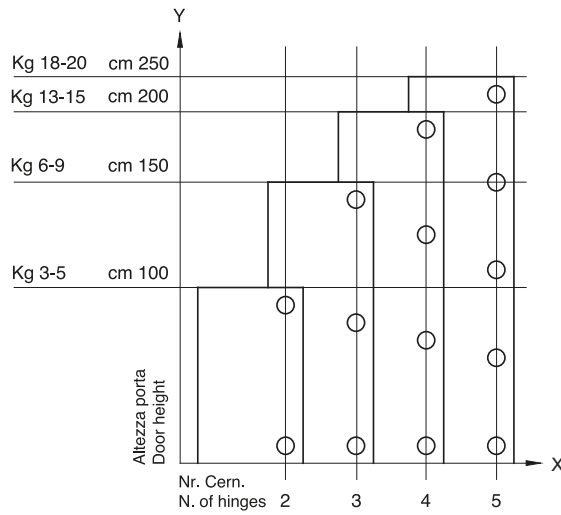
18

Numero di cerniere per porta Number of hinges per door

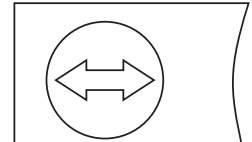
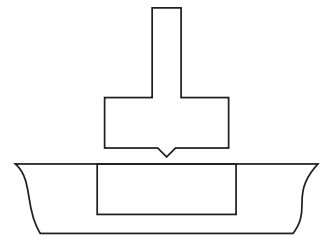

Spessore porta 18 mm / Thickness of door 18 mm

Foratura anta Door drilling

Foro - hole \varnothing 35 mm

Profondità - depth 12.5 mm

Schema di montaggio - Assembly diagram

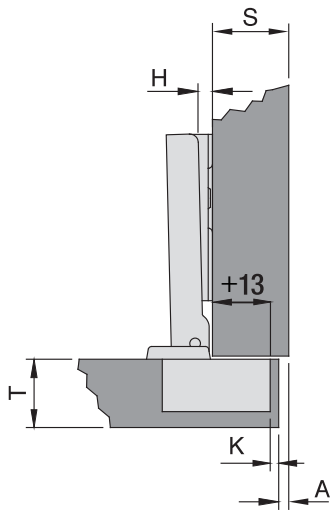
Collo / Crank full overlay "0"



$$H = (13 + K + A) - S$$

Collo / Crank full overlay "9"

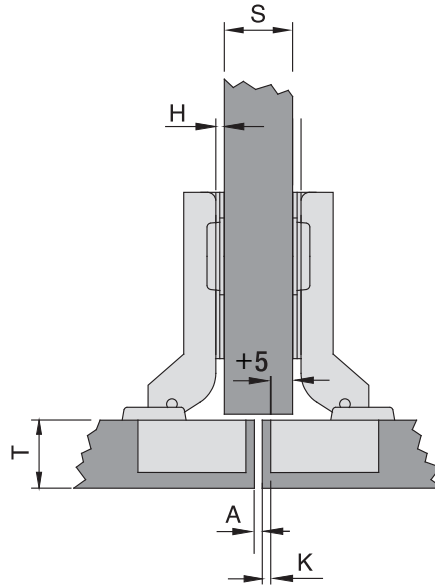

$$H = (5 + K + A) - S/2$$

Collo / Crank inset "18"

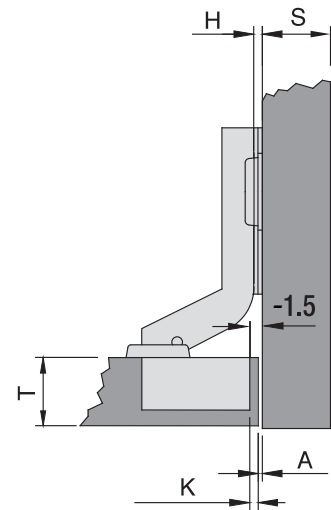

$$H = K + A - 1.5$$

 T=

16	17	18	19	20
----	----	----	----	----

K=	16	17	18	19	20	A
K=3	0.3	0.8	1.3	2.1	3.0	
K=4	0.3	0.6	0.9	1.7	2.5	
K=5	0.3	0.6	0.8	1.5	2.1	
K=6	0.3	0.5	0.7	1.3	1.7	

Angoli di apertura / Opening angles

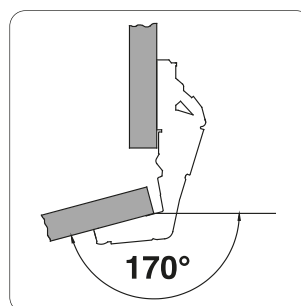
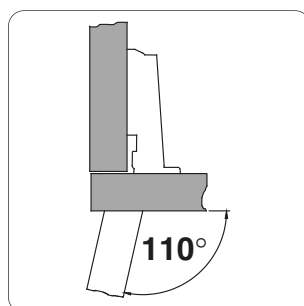

Lista delle abbreviazioni

List of abbreviations

C

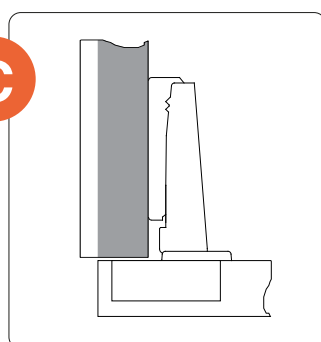
 Sormonto
Overlay

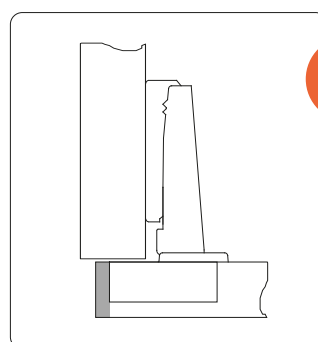
K

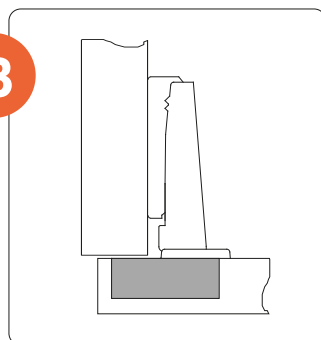
 Distanza foratura
Drilling distance

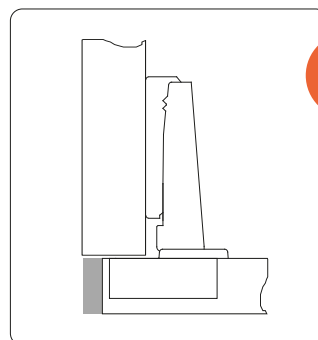
B

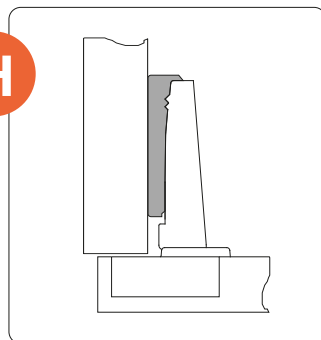
 Diametro foratura
Drilling diameter

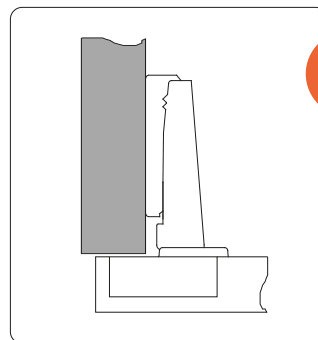
A

 Fuga minima
Minimum gap

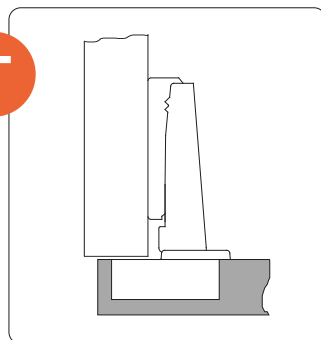
H

 Altezza della base
Height of m/plate

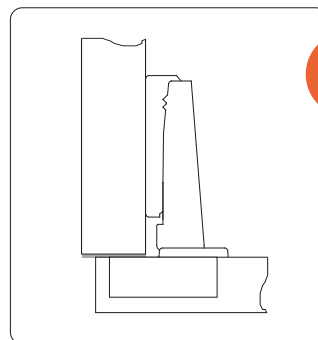
S

 Spessore fianco
Side panel thickness

T

 Spessore porta
Door thickness

L

 Fuga di chiusura
Closing gap

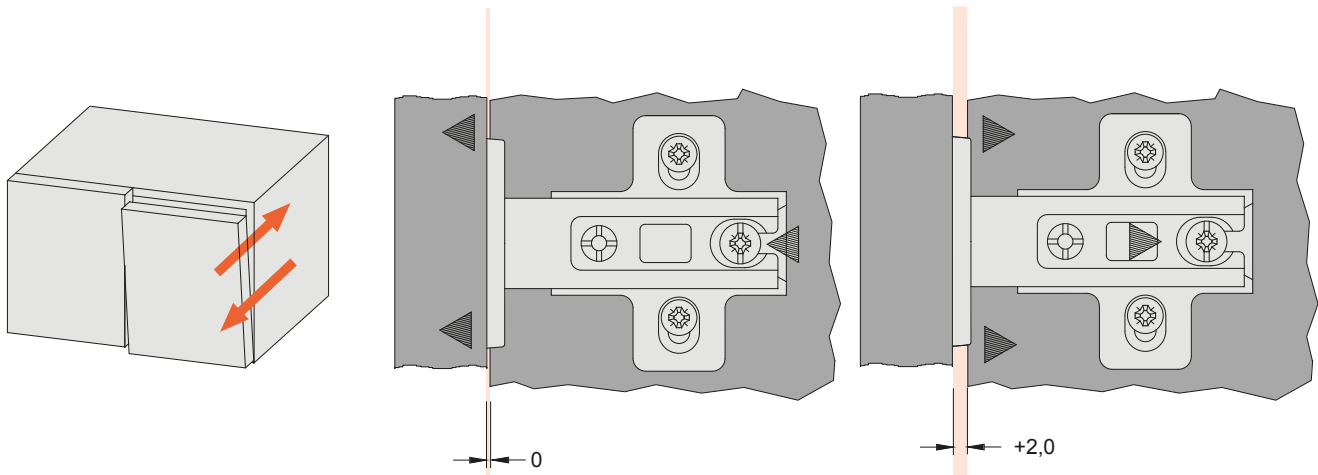
Sistemi di regolazione slide-on - Slide-on adjustments

Regolazione frontale - Front adjustment



Regolazione laterale - Side adjustment

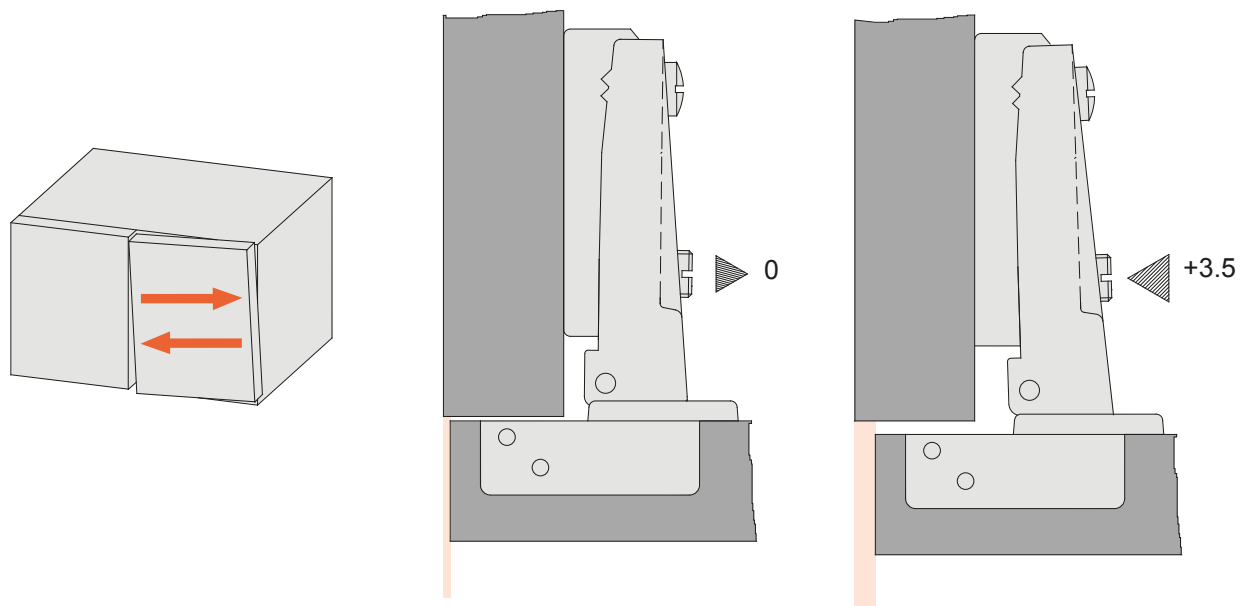

Regolazione verticale - Vertical adjustment

