

C55

**Cerniere clip-on - Ø 35 - chiusura
ammortizzata - basetta in linea**

*Clip-on hinges - Ø 35 - soft
closing - in-line mounting plate*



C55

Cerniere clip-on - Ø 35 - chiusura ammortizzata - basetta in linea Clip-on hinges - Ø 35 - soft closing - in-line mounting plate

Collo "0"
Sormonto fino 18mm.

Crank "0"
Full overlay application (up to 18mm).



$$H=13+K-C$$

$$K=2,5\div 6$$

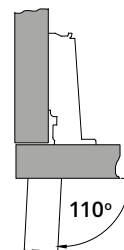
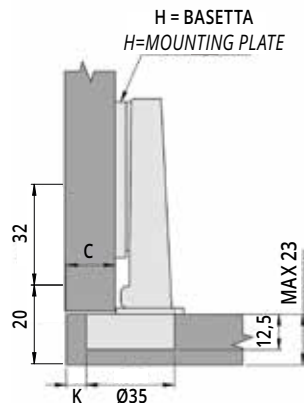

← 100 **CHIUSURA AMMORTIZZATA**
SOFT CLOSING

| | | | | |
|-----------------------------------|--|--------------------|--|--|
| Fissaggio a vite Screw-on | 3,5x16 non inclusa not included | C55A476R.7 | | |
| Fissaggio a pressione Knock-in | Ø10 premontato pre-assembled | C55A476RM.7 | | |

Collo "9"
Sormonto fino 11mm.

Crank "9"
Half overlay application (up to 11mm).



$$H=5+K-C$$

$$K=2,5\div 6$$

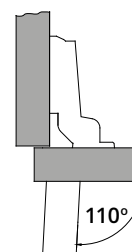
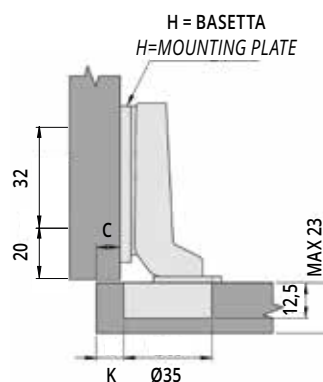

← 100 **CHIUSURA AMMORTIZZATA**
SOFT CLOSING

| | | | | |
|-----------------------------------|--|--------------------|--|--|
| Fissaggio a vite Screw-on | 3,5x16 non inclusa not included | C55B467R.7 | | |
| Fissaggio a pressione Knock-in | Ø10 premontato pre-assembled | C55B467RM.7 | | |

C55

Cerniere clip-on - Ø 35 - chiusura ammortizzata - basetta in linea Clip-on hinges - Ø 35 - soft closing - in-line mounting plate

Collo "18"
Per ante interne.

Crank "18"
Inset application.

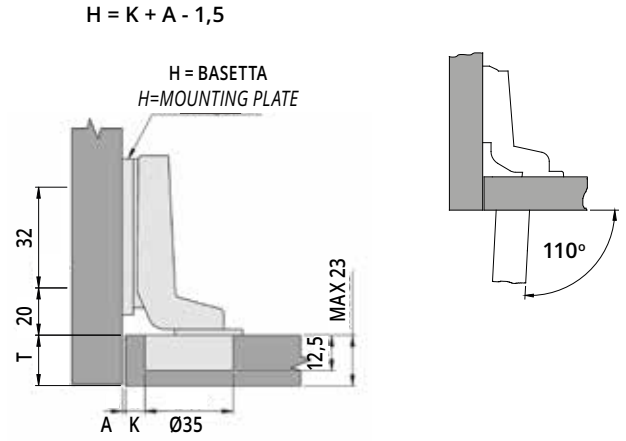

| | | ← 100 | CHIUSURA AMMORTIZZATA SOFT CLOSING | | |
|-----------------------------------|--|--|--|--|--|
| Fissaggio a vite Screw-on | | 3,5x16 non inclusa not included | C55C476R.7 | | |
| Fissaggio a pressione Knock-in | | Ø10 premontato pre-assembled | C55C476RM.7 | | |

Basette di montaggio

Mounting Plates

Base in linea in acciaio nichelato con fissaggio a vite e regolazione 3D - Steel nickel plated, in-line mounting plate, wood screw fixing and 3D adjustment

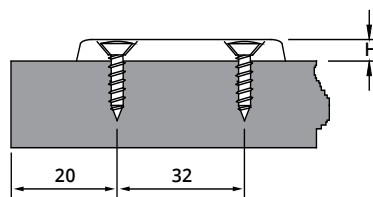

| H | Codice Code |
|------|----------------|
| 0 mm | B00TMSLIN55.7 |
| 2 mm | B20TMSLIN55.7 |

Accessori
Accessories

C30 - Placchetta copriscatola in acciaio - C30 - Steel cup cover

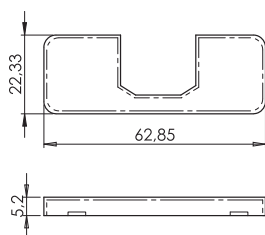

| | Codice Code |
|-----------------------|----------------|
| Senza logo No logo | PS30-AC.10 |

C30 - Placchetta copribraio in acciaio - C30 - Steel arm cover

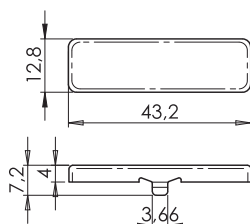

| | Codice Code |
|--|----------------|
| Senza logo No logo | PB30-AC.10 |
| Con logo cliente With customized logo | PB30-AC...10 |

C50/C54 - Placchetta copriscatola in acciaio - C50/C54 - Steel cup cover

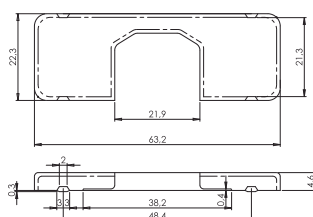

| | Codice Code |
|-----------------------|----------------|
| Senza logo No logo | PS50-AC.10 |

C50/C54 - Placchetta copribraio in acciaio - C50/C54 - Steel arm cover

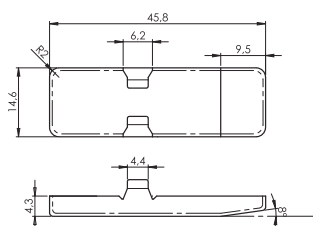
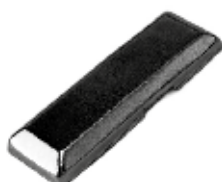

| | Codice Code |
|--|----------------|
| Senza logo No logo | PB50-AC.10 |
| Con logo cliente With customized logo | PB50-AC...10 |

Euro48 - Placchetta copriscatola in acciaio - Euro48 - Steel cup cover

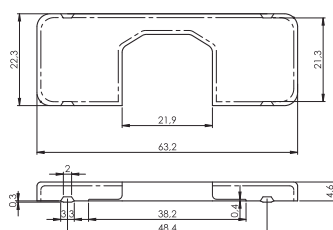

| | Codice Code |
|-----------------------|----------------|
| Senza logo No logo | 2000LM |

Euro48 - Placchetta copribraio in acciaio - Euro 48 - Steel arm cover

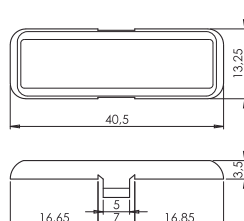

| | Codice Code |
|--|----------------|
| Senza logo No logo | 3000LM |
| Con logo cliente With customized logo | 4000LM |